

# INSTALLATION GUIDE

Sorento

SRTWT51012 , SRTWT51012-BL , SRTWT51012-GM , SRTWT51012-GY ,  
SRTWT51012-FRG

1. Please check the accessories listed in "Accessories List" after opening the product. Check whether the spare parts are complete. If there is any defect, please contact your local dealer immediately.
2. Before connecting the inlet pipe, remove the sediment and debris from the pipe. Prevent blockage of the main body and affect the water flow.
3. The height of the bathtub matches the installation size of this product.

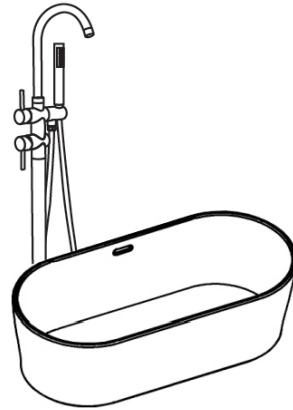

## Parts List

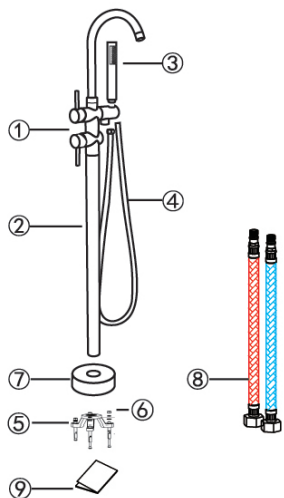

Code	Product Name	Quantity
1	Main body	1
2	Connecting pipe	1
3	Hand shower	1
4	Shower hose	1
5	Three-prong fixed seat	1
6	Expansion screw	3
7	Bottom basin	1
8	Inlet pipe	2
9	Manual	1

## Installation Steps

Interface size G1/2 (4 points)

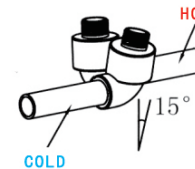

1. The two connecting ports are inclined 15 degrees in different directions and close together to facilitate the connection of the braided tube.

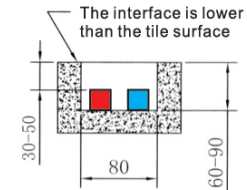

2. Construct the water inlet pipe as shown in the figure.

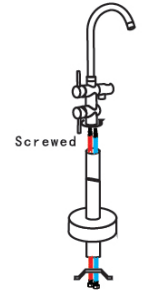

3. First string the straight pipe, decorative cover and Three-prong fixed seat on the hose, and then screw the hose to the main body.

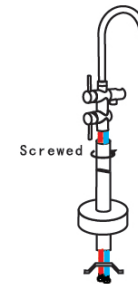

4. Connect the straight pipe to the main body.

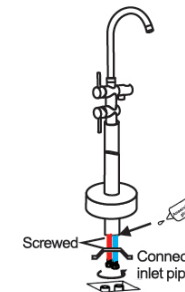

5. The braided pipe is inserted through the opening of the straight pipe, connected to the main body of the faucet, and the straight pipe is also connected and tightened.

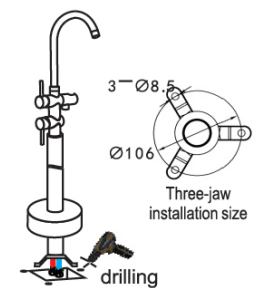

6. Punch holes according to the size drawing line, and fix the three-prong fixed seat on the floor.



7. Fix the faucet assembly with the expansion screw.



8. Screw the shower hose to the main body and the hand shower respectively.

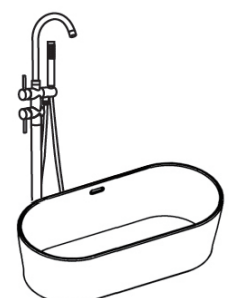

9. The installation is complete.